

Key Features & Benefits:

- Modular Design
- Easy to Adjust Light Angle
- Anti-Corrosion & Powder Coating
- Up to 140 lm/W High Efficiency Energy Saving
- Comes with 10kV Built-In Surge Protection

Project: _____

Date: _____

Catalog #: _____

Notes: _____

Product Specifications:

Power: 200 Watts, 400 Watts, 600 Watts

Lumen Output:

200W—28,000 Lumens

400W—56,000 Lumens

600W—84,000 Lumens

Efficacy (lm/W): Up to 135 Lumens per Watt

Kelvin: 4000K, 5000K

CRI: >70

Power Frequency: 50/60Hz

Power Factor: >0.92

Operating Temperature: -22°F–104°F (-30°C–40°C)

Input Voltage: 120–277 VAC, HV 277–480 VAC

Estimate L70 Lifetime 130,000 Hours calculated per TM21

Warranty: 7 Year Warranty

Product Weight:

9.04 lbs — 200W

20.72 lbs — 400W

33.73 lbs — 600W



Certifications & Ratings:

Vibration Test: ICE60068-2:1995

Wind Force Test: IEC/EN 60598-2-5; 5.6.5

IK08 Rating



Ordering Guide:

ESL	TYPE	WATTAGE	GENERATION	KELVIN	INPUT VOLTAGE	LENS	OPTIONS
ESL	HOFL	(yy)W	2	(xx)	(zz)	(bb)	
	(HOFL) High Output Flood Light	200W 400W 600W	(2) 2nd Generation	(40) 4000K (50) 5000K	(Blank) 120–277 VAC (HV) 277–480 VAC	(L44) (L55) (L55N) Narrow	

FACTORY INSTALLED OPTIONS

ESL-ACCS-PC-JL403C | Photocell (Only available for 120–277VAC option)

FIELD INSTALLED ACCESSORIES

ESL-HOFL2-VS | VISOR



Catalog Data:

ITEM#	WATTAGE	KELVIN (xx)	LUMENS	EFFICACY lm/W	INPUT VOLTAGE (zz)	DIMENSIONS (LxWxH)
ESL-HOFL-200W-2xx-Lbb	200W	(40) 4000K (50) 5000K	28,000	140	(Blank) 120–277 VAC (HV) 200–480 VAC	12.44"x12.64"x4.65"
ESL-HOFL-400W-2xx-Lbb	400W	(40) 4000K (50) 5000K	56,000	140	(Blank) 120–277 VAC (HV) 200–480 VAC	16.5"x13.39"x8.74"
ESL-HOFL-600W-2xx-Lbb	600W	(40) 4000K (50) 5000K	84,000	140	(Blank) 120–277 VAC (HV) 200–480 VAC	20.83"x13.39"x8.9"

Lighting Distribution:

LENS 44 (NEMA TYPE 4X4)

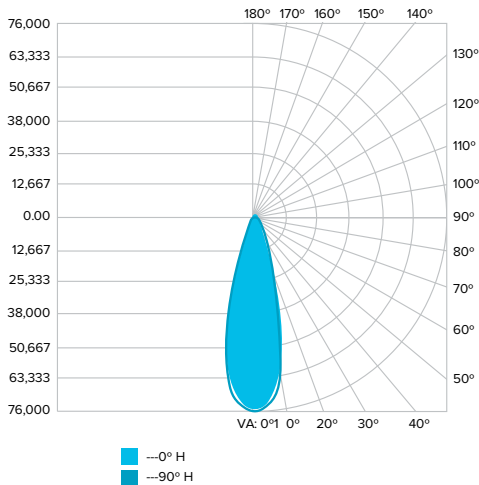

LENS 55 (NEMA TYPE 5X5)

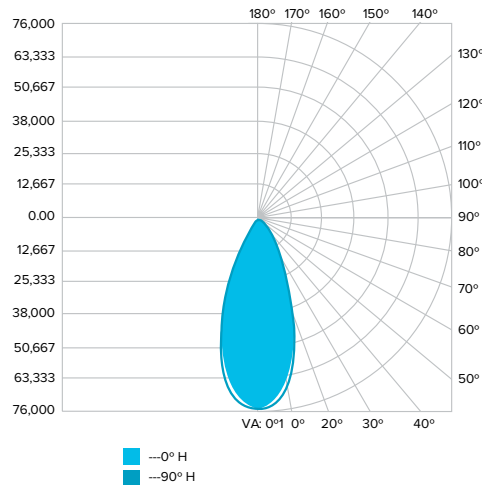

LENS 55N (NEMA TYPE 5X5 NARROW)

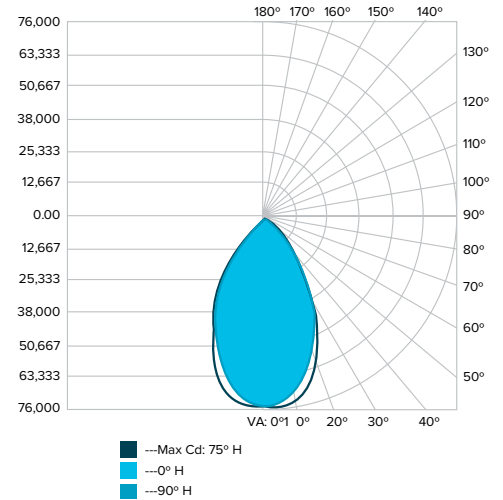

Lumen Ambient Temperature (LAT) Multipliers:

AMBIENT		LUMEN MULTIPLIER
0 °C	32 °F	1.02
10 °C	50 °F	1.01
20 °C	68 °F	1.00
25 °C	77 °F	1.00
30 °C	86 °F	1.00
40 °C	104 °F	0.99
50 °C	122 °F	0.96

Fixture Dimensions:

200W

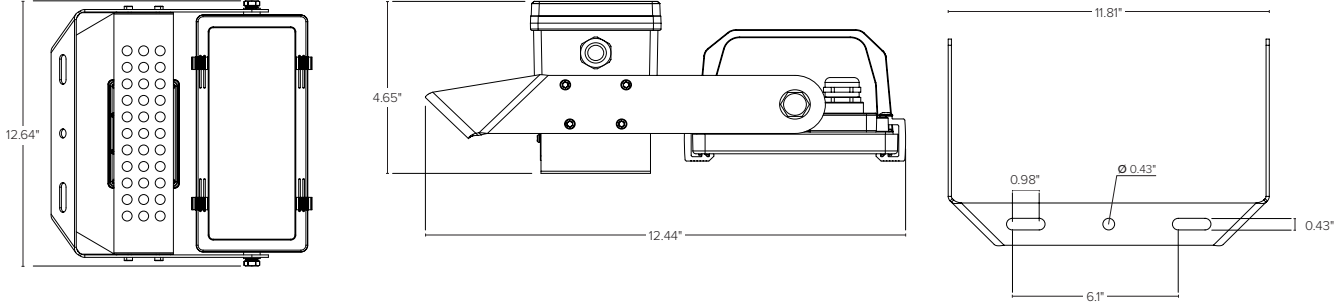

400W

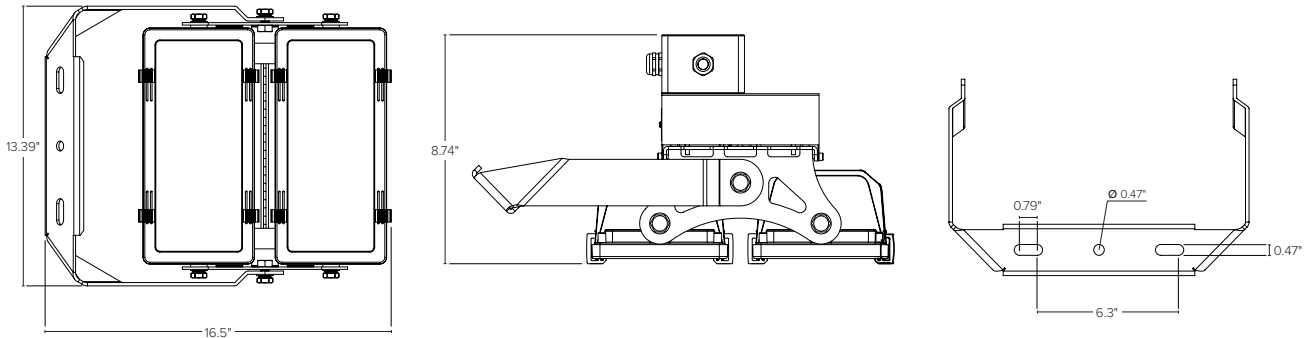

600W

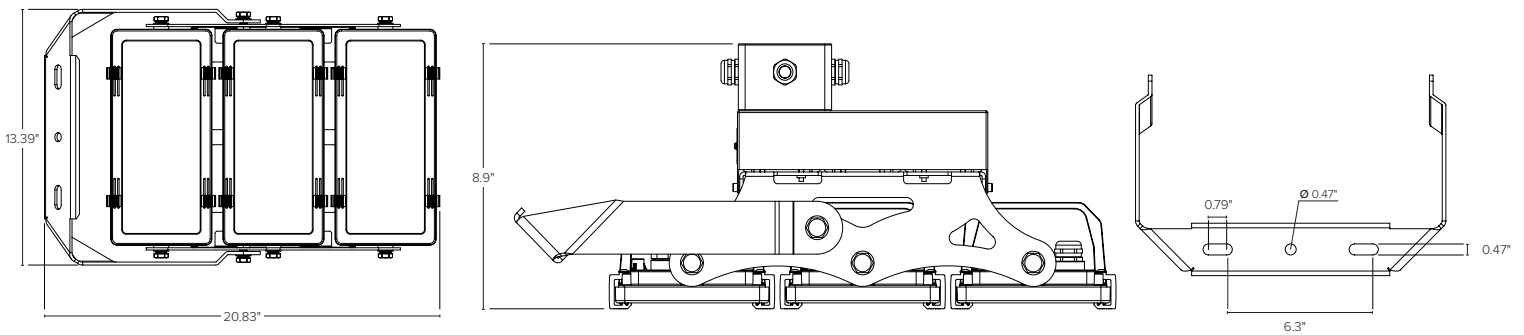

Accessories:

VISOR: ESL-HOFL2-VS

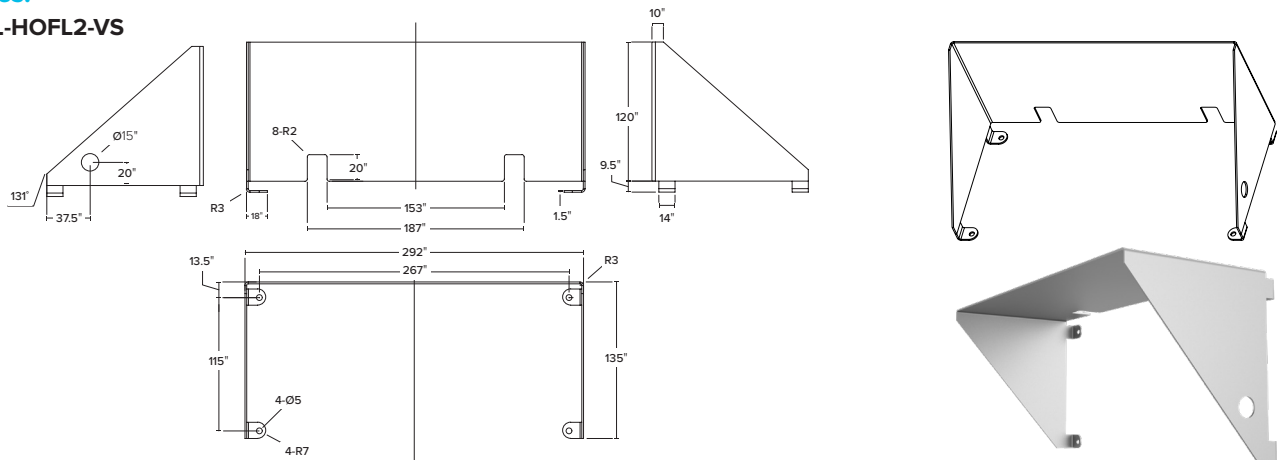

Fixture Mounting:

200W

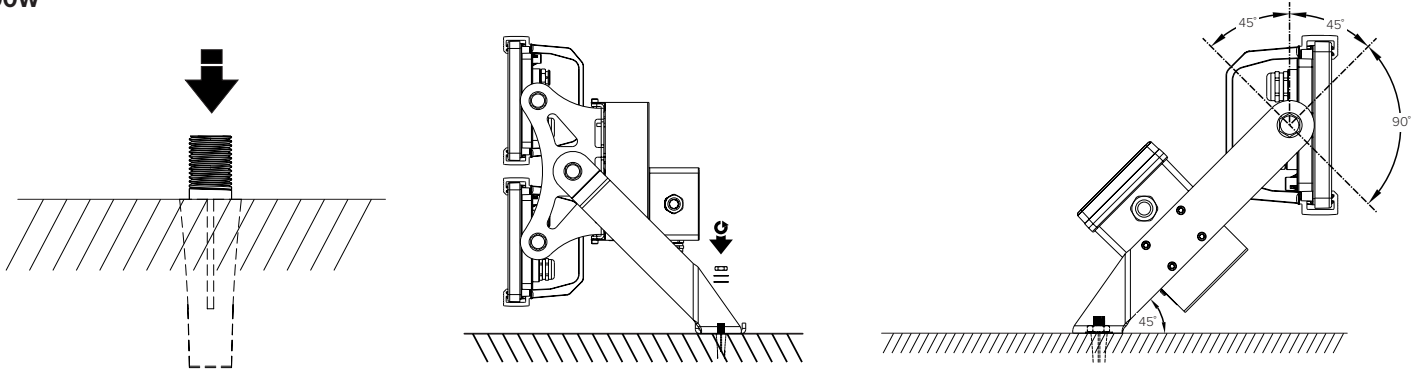

400W

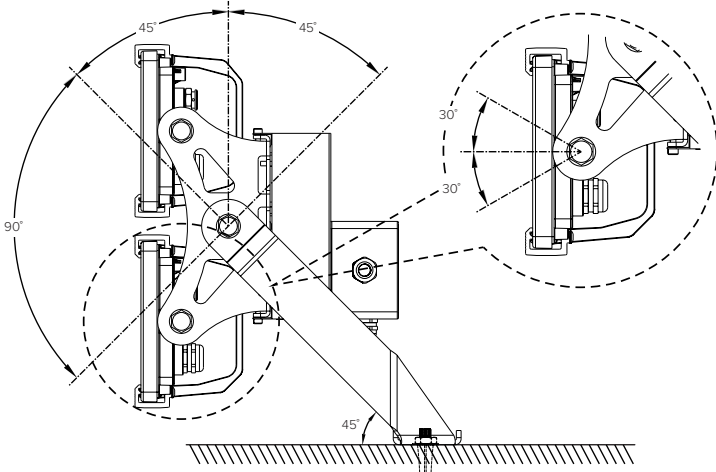

600W

